

## Structure Sensor Setup Instructions

1. Connect Structure Sensor to iPad and make sure both are fully charged.
2. Go to the App store and search "Structure" to download the below Apps.

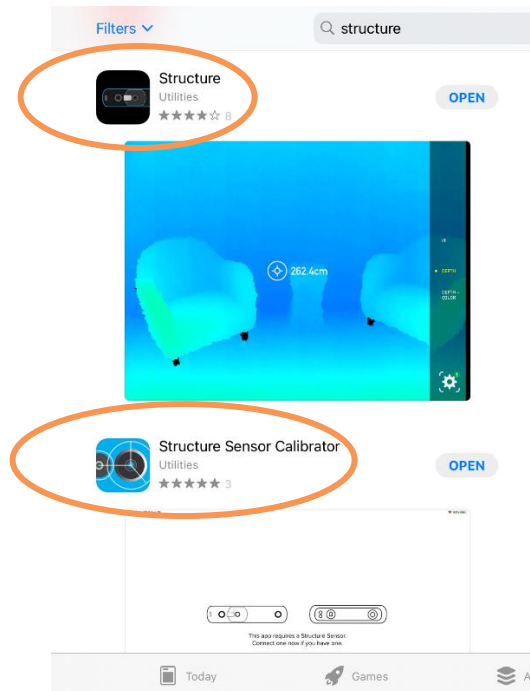

3. Open the Structure App

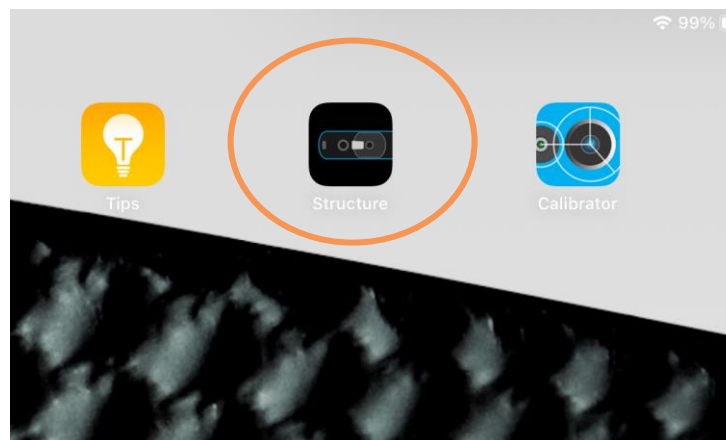

4. Click the “i” symbol in the upper right corner to verify you have the latest firmware.

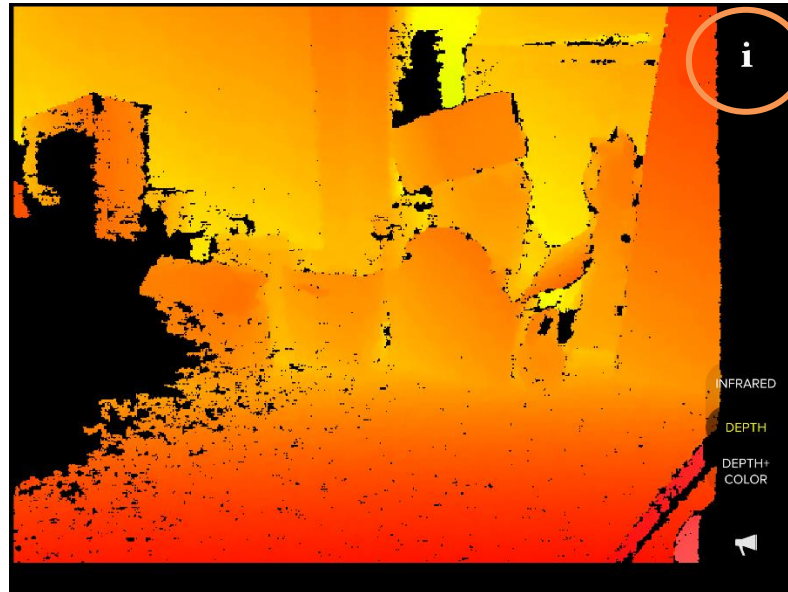

The firmware should be 1.0 or greater. (If update is available click “update firmware”)

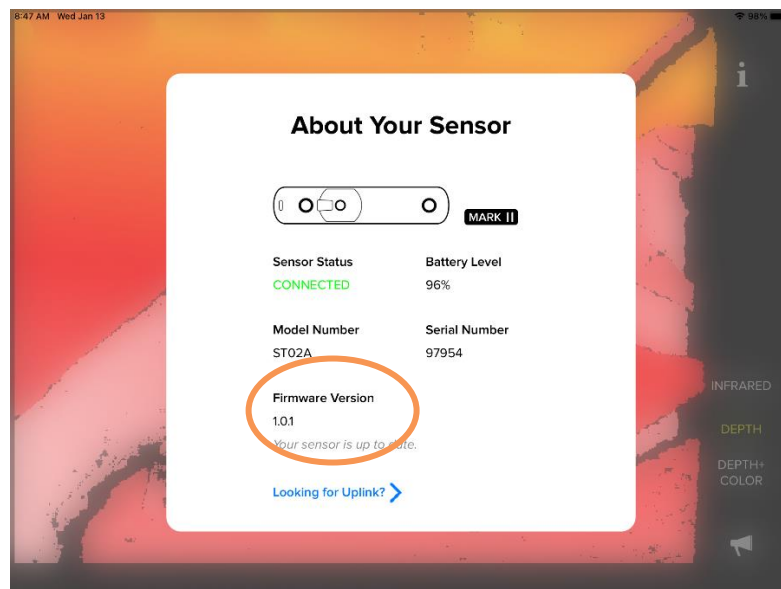

During any firmware updates, please do not disconnect the sensor cable, do not press the home button or the power button on the iPad.

5. Close the Structure App, then open the Structure Calibrator App.

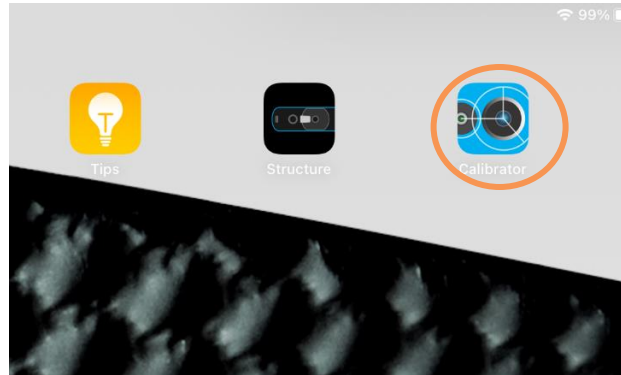

Make sure it's on Standard Calibration then select "Start Standard Calibration".

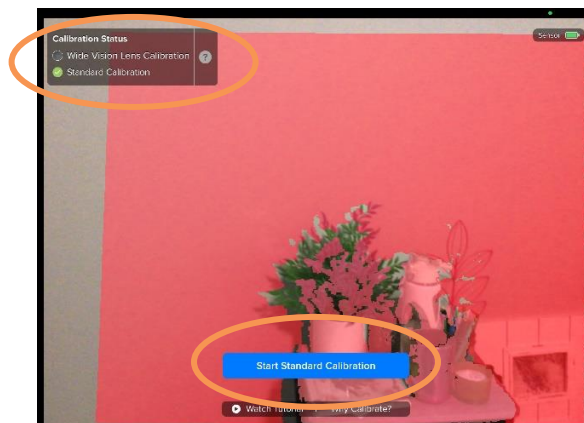

Select "Begin Calibration".

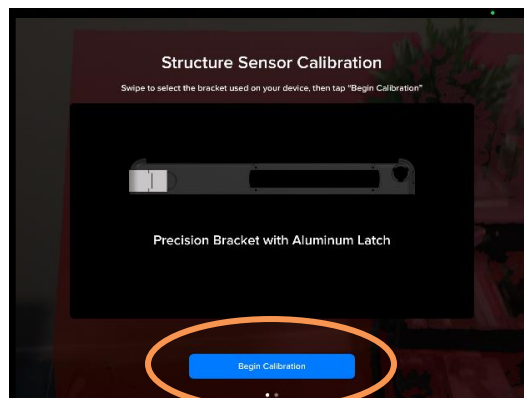

6. Ensure proper lighting is in the room and select “Enable Indoor Mode”.

**\*IMPORTANT\* Direct sunlight will be problematic for scanning.  
Please close window blinds when scanning patients.**

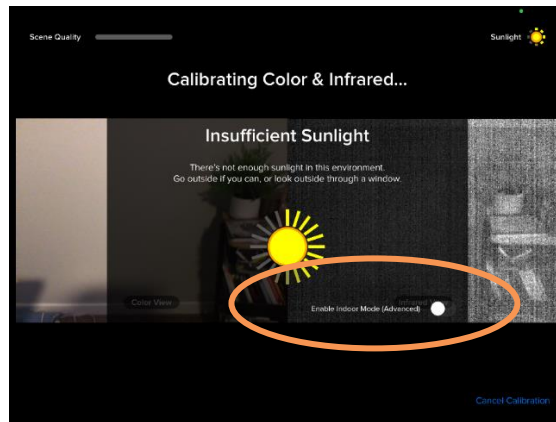

7. Follow onscreen instructions to complete the calibration process.

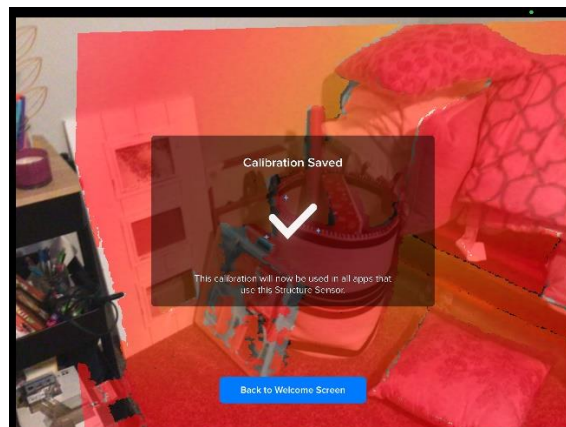
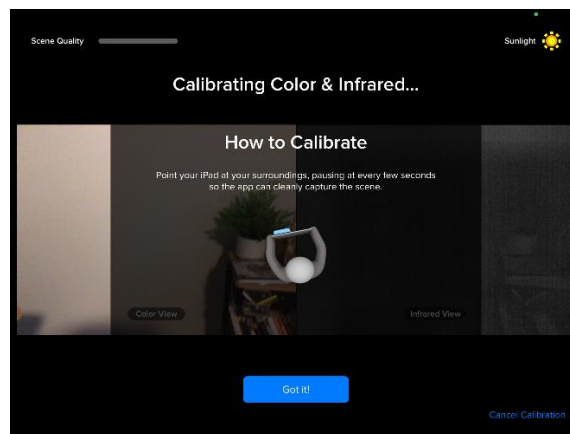

After calibration is complete, click the “?” in the upper left corner to perform image refinement.

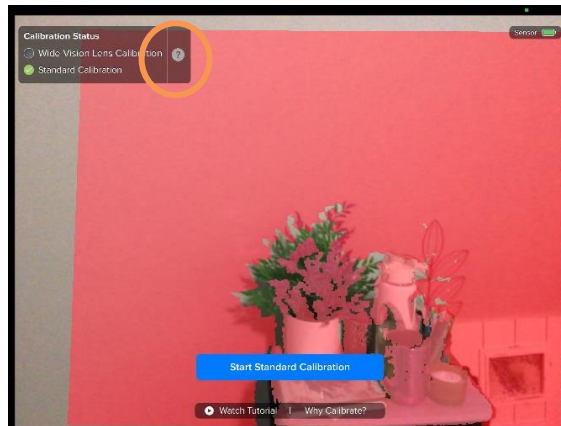

Choose a blank wall in the room to point the iPad at, then click “Perform Refinement”.

(Please hold iPad still during this process)

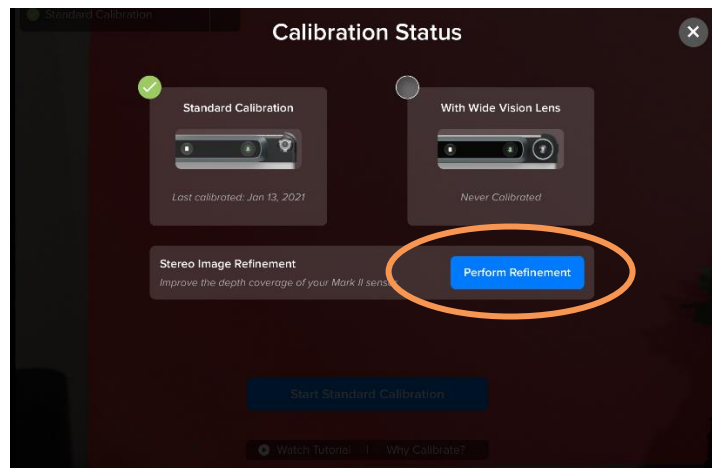

Follow onscreen instructions for image refinement, then click “Start Refinement”.

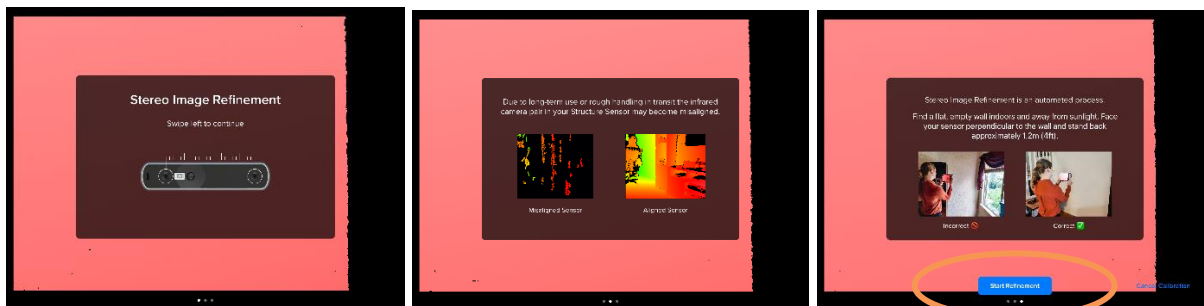

8. After image refinement is complete, close Calibrator App and open the SmartCast App.

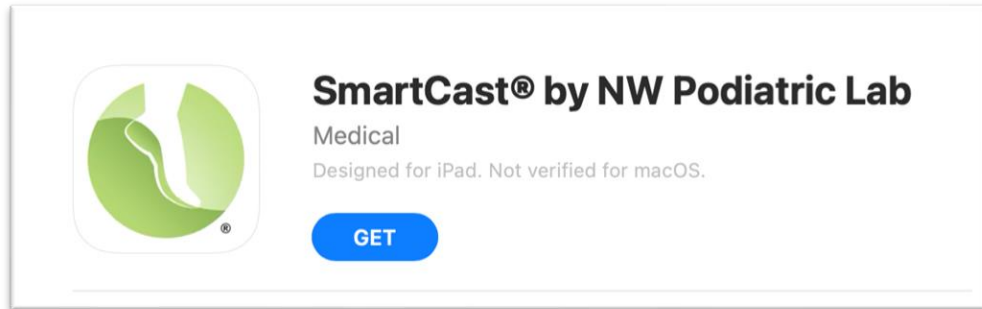

9. Create a test order and run test scans to ensure the sensor is locking onto objects and tracking correctly.
- Scans should not look “pillowy” and should be smooth with very few holes.

For any questions, please contact us at [info@nwpodiatric.com](mailto:info@nwpodiatric.com) or 800-675-1766